

58-FC1-120

120 PSI, 115VAC FLOOR CARE PUMP

Flow : With #2 Nozzle: 95 PSI, .4 GPM

With #6 Nozzle: 60 PSI, .75 GPM

FEATURES:

Series 5800 Pump
Floor Care Applications
115 VAC Operation
3/8" NPT Female Ports
Pressure Switch Set to 120 PSI
Internal Pressure Bypass
Sealed Motor to Prevent Moisture Intrusion
Steel Mounting Plate (Other Types Available)

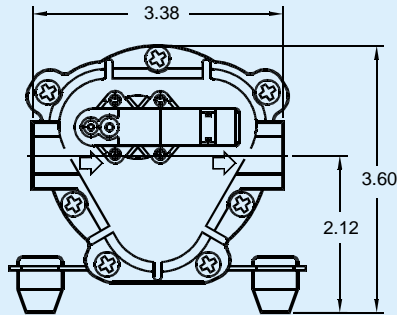

SPECIFICATIONS:

■ MOTOR:

TYPE:

115 VAC, 60 HZ, Permanent Magnet,
Totally Enclosed, Non-Ventilated

LEADS:

18 AWG, 12" LONG

TEMP. LIMITS:

For User Safety, Optimal Performance, and
Maximum Motor Life, This Motor is Equipped
with a Thermal Protector that Limits the Motor
Shell Temperature to 145°F (63°C), as Shown on
the Heat Rise Graph.

DUTY CYCLE:

See Heat Rise Graph

■ PUMP DESIGN:

3 Chamber Diaphragm Pump, Self Priming,
Capable of Being Run Dry

■ TYPICAL APPLICATION:

Floor Care

■ MATERIALS:

HOUSINGS:

Nylon

VALVES:

Viton

DIAPHRAGM:

Santoprene

FASTENERS:

Stainless Steel, Zinc Plated Carbon Steel

■ LIQUID TEMPERATURE:

170°F (77°C) Max.

■ PUMP CERTIFICATIONS:

UR E225352 (5883-2I61-0584-UR)

■ PRIMING CAPABILITIES:

9 Feet

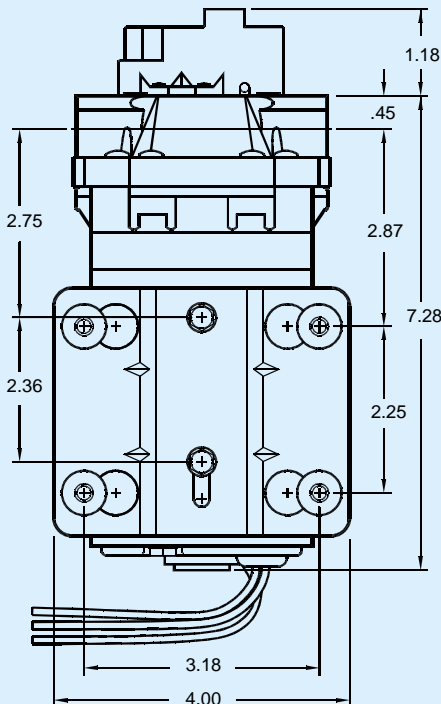

WEIGHT: 6 lbs.

58-FC1-120

120 PSI, 115VAC FLOOR CARE PUMP

PERFORMANCE DATA			
NOZZLE SIZE	DISCHARGE PRESSURE (PSI)	FLOW (GPM)	CURRENT (AMPS)
NUMBER 2	95	0.40	0.90
NUMBER 6	60	0.75	0.80

PERFORMANCE MEASURED WITH FLOODED INLET (0 PSI), 70°F (21°C) AMBIENT AND WATER TEMPERATURE, AND VOLTAGE CONTROLLED AT 115 VAC. POSITIVE INLET PRESSURE WILL INCREASE THE DISCHARGE PRESSURE BY A SIMILAR AMOUNT, FOR A GIVEN FLOW. MAXIMUM INLET PRESSURE IS 60 PSI.

NOTES:

- NOT RECOMMENDED FOR NOZZLES SMALLER THAN NUMBER TWO
- REQUIRES MINIMUM SYSTEM PRESSURE RELIEF VALVE SETTING OF 225 PSI WITH HEATER EQUIPPED UNITS

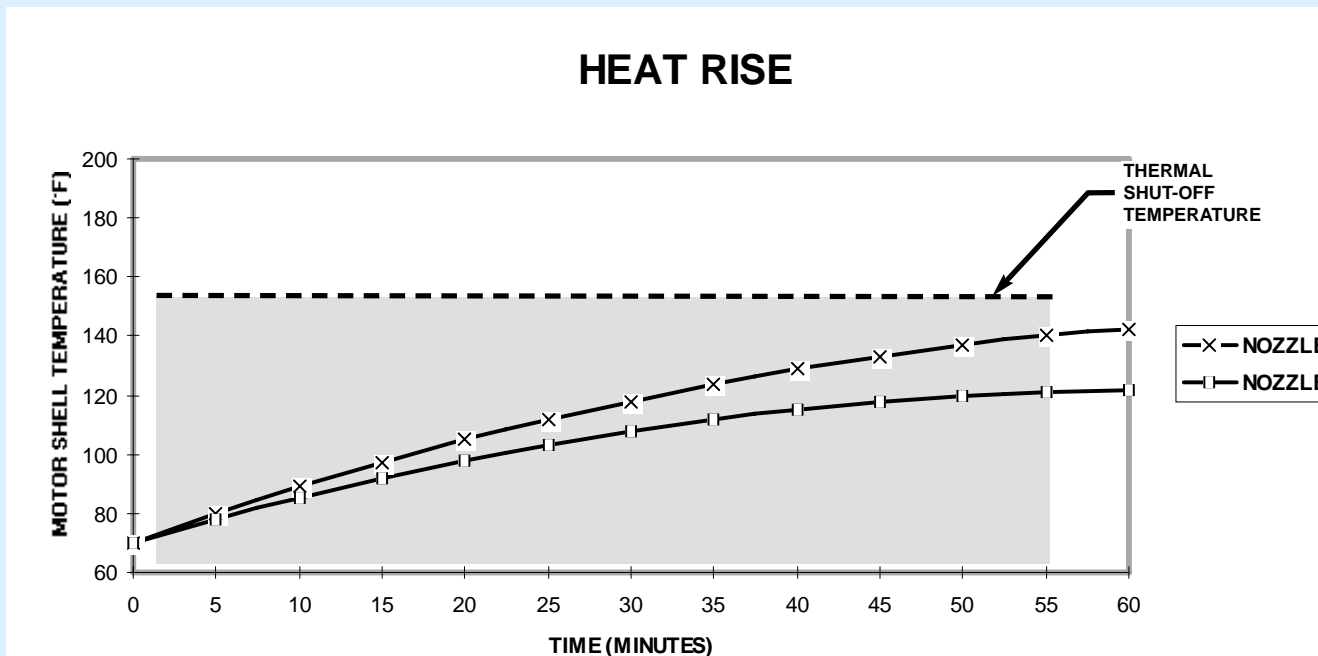

The motor driving this pump has a built in thermal protector that will open, shutting off the pump, when the surface temperature of the motor heats to approximately 150°F. Motors of this size and construction require 15 to 30 minutes of cooling time before the thermal protector closes and re-energizes the pump. Lower current levels heat more slowly, allowing longer run times, but the cool down time still averages about 30 minutes, at 70°F ambient temperature.

ALL PERFORMANCE AND HEAT RISE FIGURES ARE APPROXIMATE. ACTUAL VALUES WILL VARY WITH AMBIENT CONDITIONS.