

# BUTLER PRO 10L DRY COMMERCIAL VACUUM CLEANER

---

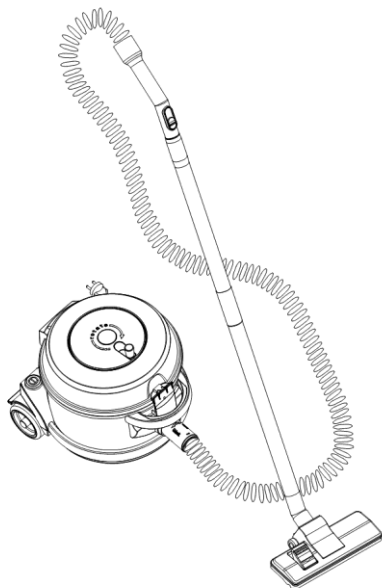

## INSTRUCTION MANUAL



---

### **Cleanstar Pty Ltd**

59 Radford Road, Reservoir VIC 3073 Australia

Ph: (03) 9460 5655 Fax: (03) 9460 5666

Email: [sales@cleanstar.com.au](mailto:sales@cleanstar.com.au)

[www.cleanstar.com.au](http://www.cleanstar.com.au)

## TIPS AND WARNINGS

---

Your Cleanstar BUTLER PRO is ready to be used immediately after removing it from the box.

When using the BUTLER PRO, please adhere to any rules and precautions applicable to operating an electric device.

After vacuuming and before cleaning or maintenance of the machine, the plug has to be disconnected from the electric socket.

This vacuum cleaner and its components are not to be used by persons (including children) with reduced physical, sensory or mental capabilities, or lack of experience and knowledge, unless they have been given supervision or instruction concerning use of the appliance by a person responsible for their safety. Children should be supervised to ensure that they do not play with the appliance.

Damaged or malfunctioning vacuum cleaner cannot be used. Only trained personnel can repair the appliance. An improper repair can cause considerable danger to the user. The manufacturer will not be held responsible for any unauthorised repair and its consequences.

If the supply cord is damaged, it must be replaced by the manufacturer, its service agent or similarly qualified persons in order to avoid a hazard.

Regularly change dust bags and inspect the filters for excessive dirtiness or damage.

# COMPONENTS OF BUTLER PRO

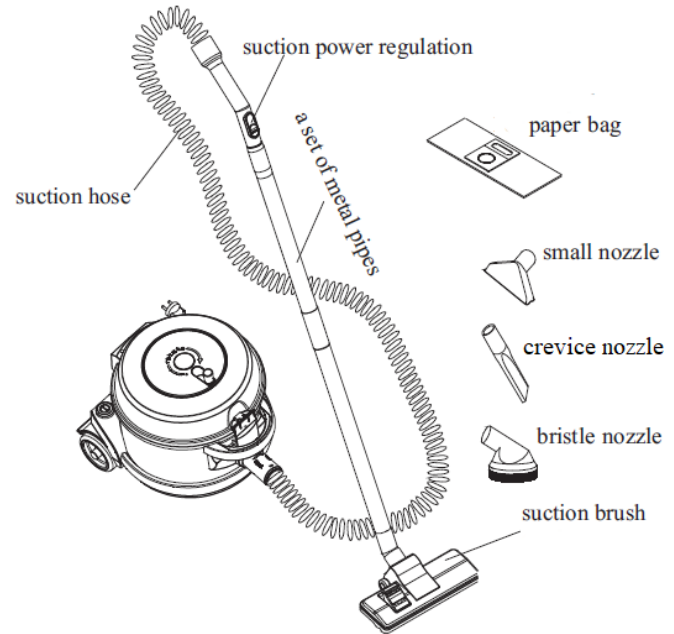
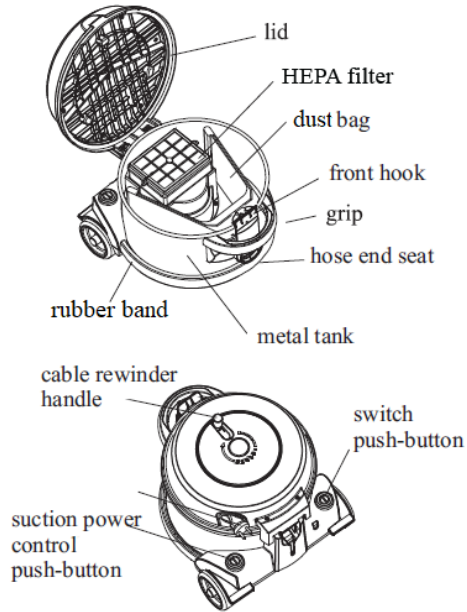

## HOW TO USE THE BUTLER PRO

---

In order to pull the cable out of the lid, simply pull on the plug.

In order to rewind the cable, switch the small handle upright and turn the winder around clockwise. Do not wind the cable in the opposite direction! It might cause the cable to jam.

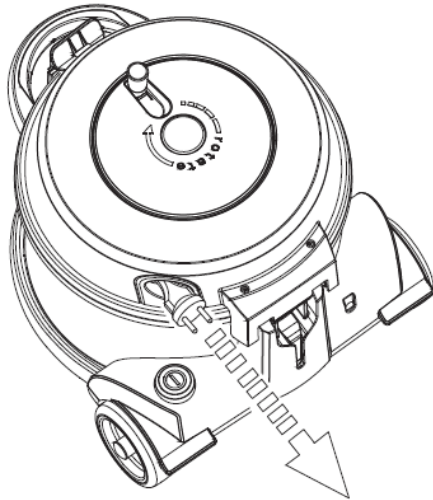

cable rewinder handle  
in folded position

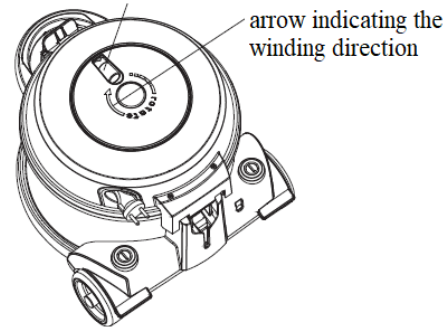

cable rewinder handle  
in working position

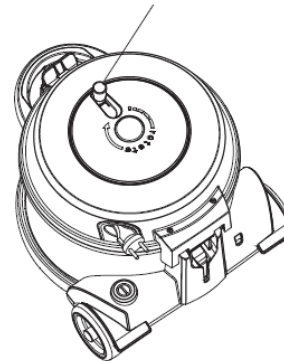

## NOZZLES

---

**Suction hose** is a basic piece of equipment of a vacuum cleaner. It is flexible, does not get tangled and makes maneuvering the machine easy. The hose handle is fitted with manual suction regulator.

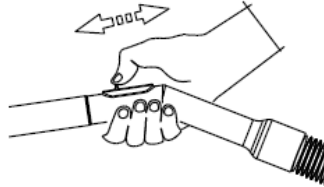

**Suction pipes** connect the hose with the nozzles and increase the working range of the vacuum cleaner. The two pipes can be joined by press fitting.

**Upholstery nozzle** is for cleaning surfaces such as upholstered furniture, window curtains, mattresses, cushions, etc.



**Bristle nozzle** is intended for vacuuming uneven surfaces such as picture frames or shelves of books.

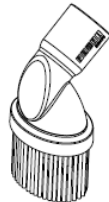

**Crevice nozzle** due to its slim shape, the nozzle enables cleaning areas which are difficult to access such as gaps, corners, recesses, etc.



**Suction brush.** This versatile accessory enables vacuuming both hard floor and carpeted surfaces. Switching the button on the tool changes its setting from hard floor to carpet and back. The extended bristle setting is perfect for cleaning hard floor surfaces. The nozzle in the carpet mode has its bristle retracted.

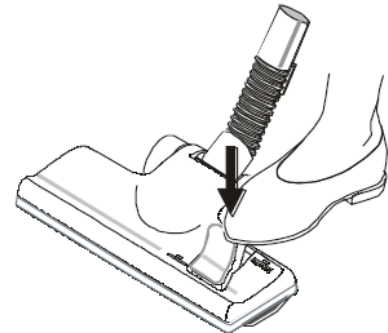

## MAINTENANCE

---

To attach or detach the suction hose, follow the drawing below.

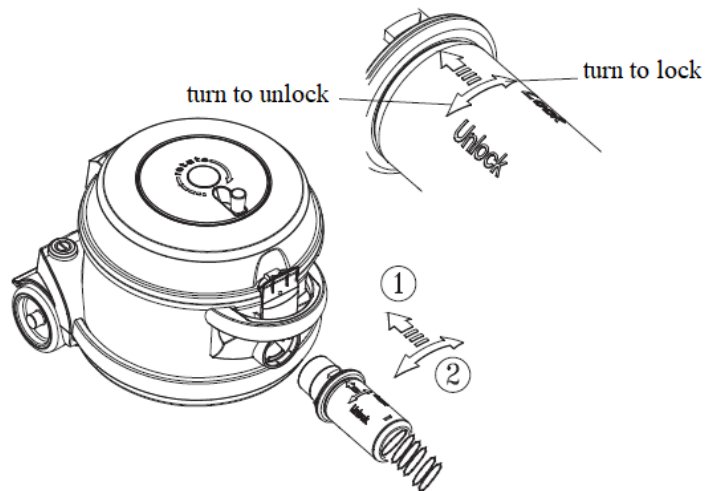

To change the suction unit inlet air filter, follow the drawing below. Using faulty or clogged filters can damage the motor!

When the suction power noticeably decreases and cleaning the filter does not help, the filter has to be replaced with a new one.

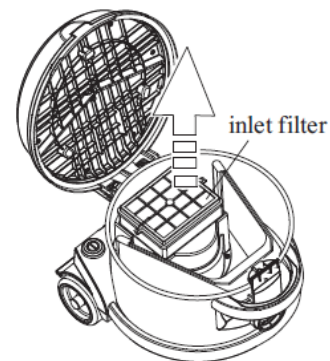

# MAINTENANCE

---

To change the dust bag, follow the three easy steps below.

Remove the hose

Remove the full dust bag, slide in a new one

Attach the hose again

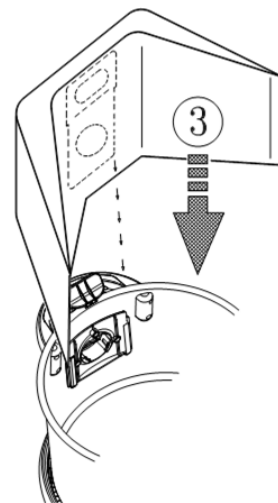
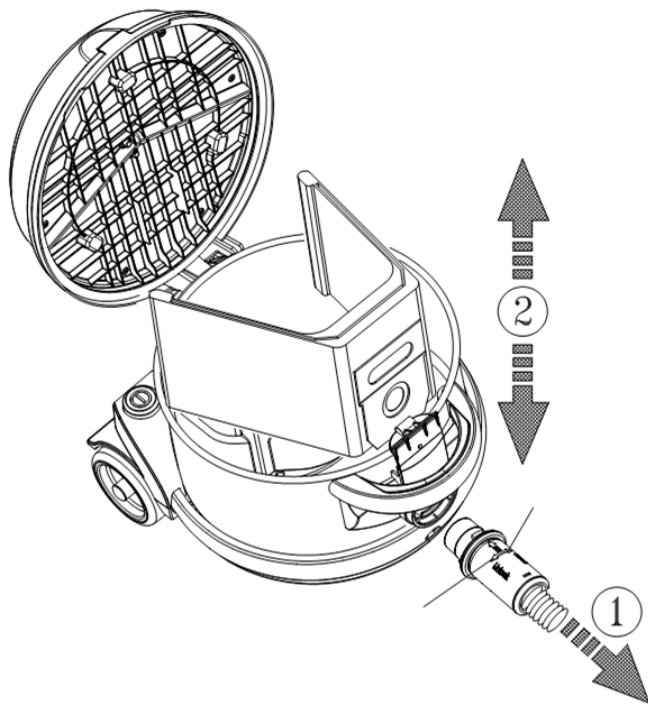

## Caring for your vacuum cleaner

---

### **Never use your vacuum cleaner for vacuuming:**

- Ash, cigarettes, matches or any hot items whatsoever.
- Glass, clips, staples or any other sharp object.
- Wet surfaces, or surfaces with spills of water or other liquids. **This unit is strictly for dry vacuuming only!**
- Plaster, cement, stone powders, concrete or wood dust, etc.

### **How to take care of your vacuum cleaner:**

- Replace a full dust bag with a new one.
- Do not overfill the dust bag.
- Check the filters regularly. Do not let them clog as this will degrade suction performance.
- Clean only the outside of the vacuum cleaner
- It is best to use a wet, soft piece of cloth with a mild cleaning agent to clean the vacuum cleaner.
- Make sure the vacuum cleaner is completely dry before using it again.

**Never use the vacuum cleaner if the dust bag is ripped or the filters damaged. This will damage the motor and void your warranty.**



# EXPLODED DRAWING

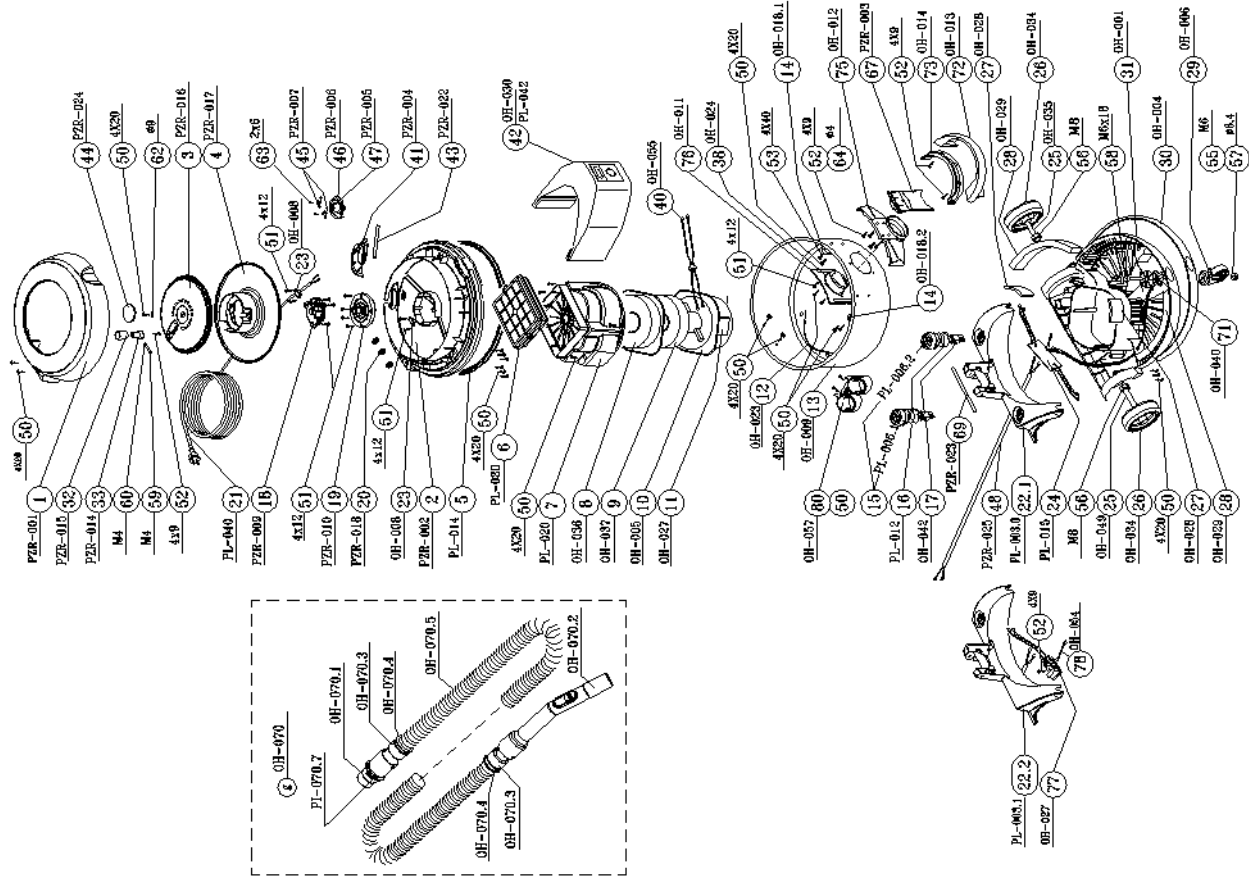



ABN: 51 121 002 104  
59 Radford Road, Reservoir VICTORIA 3073  
Phone: (03) 9460 5655 Fax: (03) 9460 5666  
Email: [sales@cleanstar.com.au](mailto:sales@cleanstar.com.au) Web: [www.cleanstar.com.au](http://www.cleanstar.com.au)

## **CONDITIONS OF WARRANTY**

**This document outlines the terms and conditions of warranty for your Cleanstar product. This is an important document that should be kept with your proof of purchase documents in a safe place for future reference should you require service for your product.**

Thank you for purchasing your new Cleanstar product. We are confident this product will give you trouble-free use and excellent service, provided the operator uses and maintains the product in accordance with the Instruction Manual. Please read the Instruction Manual carefully before using the product for correct operation and maintenance procedures, and store it in a safe place for future reference.

1. This is a parts and labour warranty against faulty or defective parts, materials or workmanship in manufacturing, when the product is used and operated in accordance with the Instruction Manual.
2. This product carries a 12 month (1 year) warranty period that commences from the original date of purchase by the first user/purchaser, and is not transferable.
3. The warranty only covers use of the product to remove dry dirt and dust from flooring and other surfaces.
4. This warranty only applies to products purchased and used in Australia.
5. At all times during the warranty period, Cleanstar shall, at its sole discretion, determine whether repair, replacement or refund will apply if the product has a valid warranty claim applicable to it.
6. The repair or replacement of the product under this warranty does not extend the original period of warranty.
7. Please note that this warranty will be voided in the following cases (which are not exhaustive) and the warranty does not apply to the cost of replacing any parts of the product resulting from:
  - Accidental damage;
  - Normal wear and tear;
  - Neglect, misuse or physical abuse by the operator, including failure to properly maintain or service;
  - Any alterations, modifications or tampering with the product without the prior written consent of Cleanstar;
  - Incomplete or improper installation;
  - Incorrect, improper or inappropriate operation;
  - Insect or vermin infestation;
  - Power surges, electrical storm damage or incorrect power supply/voltage;
  - Excessive use or use for which this product has not been designed;
  - Vacuuming up water, liquids, toner, powders, glass, hazardous, flammable or corrosive materials, plaster dust, concrete dust and other similar building or construction materials;
  - Failure to comply with the operating instructions contained in the Manual supplied with the product;
  - If the product is rented;
  - If the product is used outside of Australia;
  - If the product was serviced or repaired by anyone other than Cleanstar, or one of Cleanstar's Authorised Service Agents (ASA). Cleanstar is unable to accept any responsibility under this warranty for any repair work not carried out by an ASA or from the use of non-genuine parts.
8. This warranty does not cover service calls, travelling time or consumable parts such as belts, dust bags, filters, hose or hose parts, rods and wands, floor tools and accessories, motor brushes and other like consumable items, unless defective in manufacture. In order to prolong the life of accessories and consumables, regular care and maintenance is recommended.
9. Please retain your original proof of purchase which will be required before you can make a claim under this warranty. If proof of purchase can not be provided at the time of a warranty claim or service, any work carried out on the cleaner is chargeable.
10. Any transportation and delivery costs involved in the repair of defective parts shall be borne by the claimant. In all instances, unless the product is transported by Cleanstar or a Cleanstar authorised representative, the product is transported at the owner's cost and risk while in transit to and from Cleanstar or its ASA.

Our goods come with guarantees that cannot be excluded under the Australian Consumer Law. You are entitled to a replacement or refund for a major failure and for compensation for any other reasonably foreseeable loss or damage. You are also entitled to have the goods repaired or replaced if the goods fail to be of acceptable quality and the failure does not amount to a major failure. The benefits conferred by this warranty are in addition to other rights and remedies under law in respect of the product to which this warranty relates.

### **TO INQUIRE ABOUT MAKING A CLAIM UNDER THIS WARRANTY, PLEASE FOLLOW THESE STEPS:**

- a) carefully check the Instruction Manual and the terms of this warranty;
- b) have the name and model number of the appliance available;
- c) have the proof of purchase available (ie. invoice, receipt, etc) showing where the appliance was purchased from and date of purchase;
- d) call Cleanstar on **(03) 9460 5655** to speak to one of our customer service staff.