

CLEANSTAR COMMERCIAL

15 LITRE COMMERCIAL STAINLESS STEEL WET 'N' DRY MACHINE



15L COMMERCIAL STAINLESS STEEL WET AND DRY 1000 WATT (240V)

COMES WITH 36mm:

- HOSE
- METAL RODS
- DRY COMBINATION FLOOR TOOL
- SQUEEGEE TOOL
- CREVICE TOOL
- DUSTING BRUSH
- UPHOLSTERY TOOL

Part No: VC15L



COMPATIBLE WITH MOTOR: M031

VC15L BREAKDOWN FIGURE

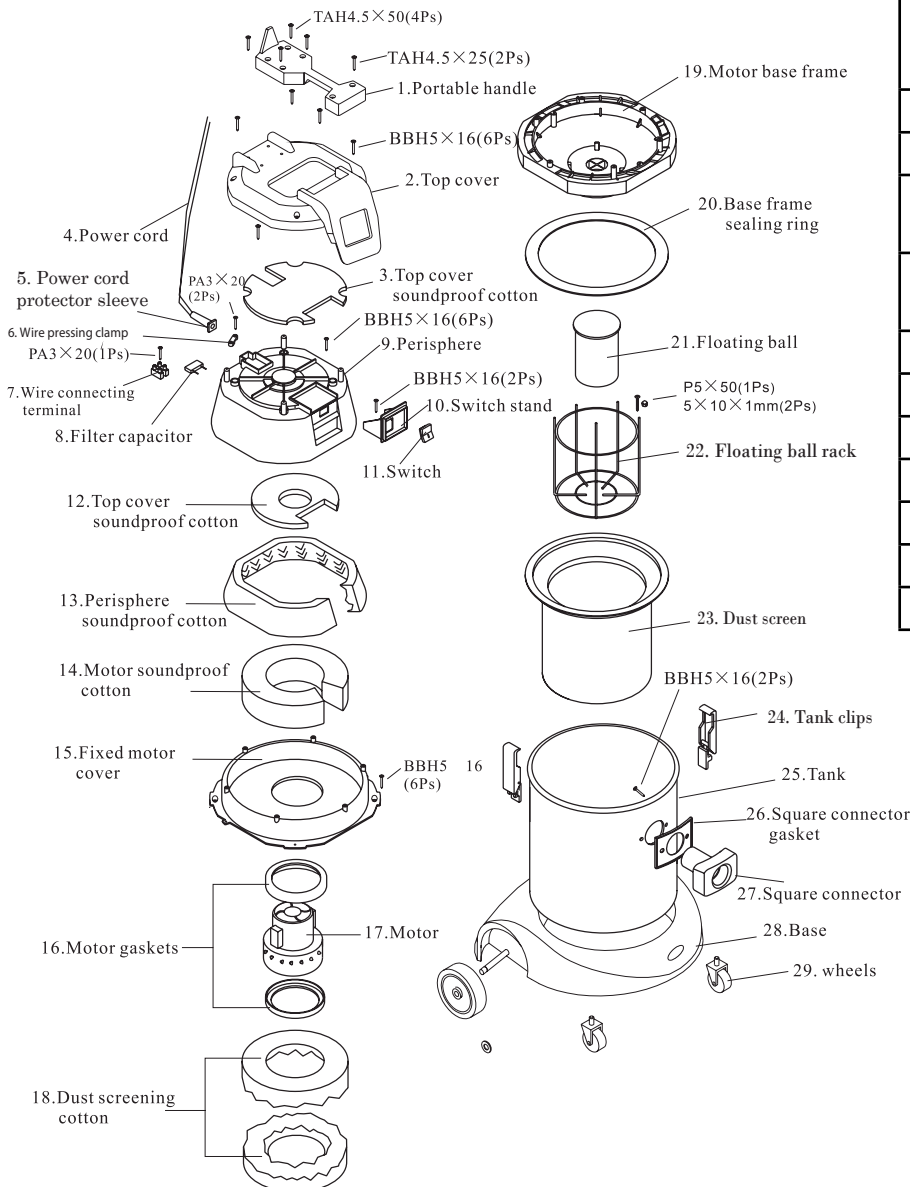

TECHNOLOGICAL PARAMETERS

TECHNOLOGICAL PARAMETERS	
Model	VC15L Stainless Steel Tank
Capacity	15 Litres
Working Voltage	220-240V
Power	1000W, single-phase
Function	Dust & water vacuuming
Air Flow Rate	48 L/s
Vacuum Suction	210 bar
Cooling Mode	Circulating
Tank Diameter	345mm
Height	580mm
Matching Part	Φ36
Power Cord	7 metres



HBCOM-36
Complete
Hose



BPB036
Bent End
Piece



ME15
Machine End



M031
Motor



RCS036
Chrome Rod



FTB136
Combination
Floor Tool



FTH136
Multipurpose
Housing



FTH136C
Housing with
Squeegee &
Brush Inserts



FTH136-1
Squeegee
Insert



FTH136-2
Brush Insert



FTH136-3
Squeegee
Floor Tool



FTH136-4
Brush/Dry
Floor Tool



CT036
Crevice Tool



UBS036
Upholstery
Brush



DBR036
Dusting Brush



CB15/30
Cloth Bag



SILK-M
Silk Filter
Gown



AF1011
Paper Dust
Bag



VC15L-1
Handle



VC15L-11
Switch



VC15L-12
Top Cover
Soundproof



VC15L-13
Perisphere
Soundproof



VC15L-14
Motor
Soundproof



VC15L-15
Motor Cover



VC15L-18
Dust
Screening



VC15L-19
Motor Base



VC15L-2
Top Cover



VC15L-20
Base Frame
Seal Ring



VC15L-21
Floating Ball



VC15L-22
Cage Float
Ball Rack



VC15L-24
Tank Clips



VC15L-25
Tank



VC15L-28
Tank Base



VC15L-29F
Front Castor
Wheel



VC15L-29R
Rear Wheel



VC15L-9
Perisphere



VC30L-26
Square Connector
Gasket Seal



VC30L-27
Square Connector
Tank

VC15L SPARE PARTS