



Instruction Manual

WET & DRY VACUUM CLEANERS



- Please read this Instruction Manual carefully before operation and follow all guidelines before using this vacuum cleaner.
- Please keep this Manual for future reference.

USER INSTRUCTIONS

1. Make sure that the power supply in the building is identical to that shown on the rating label/voltage plate.
2. Assemble the suction hose, tubes and suitable floor tool/nozzle.
3. Connect suction hose to tank connector of the vacuum cleaner.
4. Place suction head on tank so that the mains cable is opposite to the suction hose connection.

INSTRUCTIONS FOR DRY VACUUM CLEANING

- Before vacuuming dry dust, make sure that the cloth filter bag is always fitted, regardless of whether a paper dust bag is used or not.
- Empty dust from the tank as required.

INSTRUCTIONS FOR WET VACUUM CLEANING

- Always make sure that the cloth filter bag and paper bags are removed before vacuuming water.
- Empty tank as required.

SAFETY RULES & CAUTIONS

1. The machine is not suitable for picking up dusts or liquids which are explosive, flammable, poisonous, or in any way represent a danger to health.
2. Check the mains cable to ensure it is ok before using the machine. Every care must be taken to avoid damaging the mains cable. If the cable is broken, damaged or becomes loose in any way, then it must be repaired or replaced before use. In case of replacement, the same quality of cable must be used.
3. All plugs and sockets used must be water-proof. Use only in 220v/240v plug and points.
4. Do not use the machine outdoors.
5. This appliance is not intended for use by persons (including children) with reduced physical, sensory or mental capabilities, or lack of experience and knowledge, unless they have been given supervision or instruction concerning use of the appliance by a person responsible for their safety.
6. Children should be supervised to ensure that they do not play with the appliance.
7. **WARNING: If the supply cord is damaged, it must be replaced by the manufacturer, its service agent or similarly qualified persons in order to avoid a hazard.**

CLEANING & MAINTENANCE

ATTENTION: THE MACHINE MUST BE SWITCHED OFF BEFORE PLUGGING INTO POWER SOCKET.

1. Always turn the machine off and disconnect the plug from the power socket before cleaning or maintenance.
2. Always keep the machine as clean and dry as possible – don't leave it for a long time with dust or water.
3. Clean the cloth bag thoroughly either by beating or brushing it.
4. The cloth bag can be washed with a little washing powder in lukewarm water and must be dried thoroughly before re-use.
5. The cloth bag must be replaced according to level of use.
6. From time to time, use a damp cloth to wipe the machine inside and out, including the mains cable. Examine at the same time the outside of the mains cable for cuts or other damage.

MALFUNCTION CAUSES / SOLUTIONS

1. The dust bag is too dirty / Clean the dust bag thoroughly.
2. There is too much waste in the dust bag or in the machine / Remove and dispose of all the waste.
3. The suction hose or the tank connector is blocked / Clear out the blockage.

VC15L VACUUM CLEANER

TECHNICAL SPECIFICATIONS	
Model	VC15L Stainless Steel Tank
Power	1000W, single phase
Cooling System	Circulating
Capacity	15L
Height	58cm
Diameter	34.5cm
Air Flow	48L/s
Vacuum Suction	210 mbar
Accessories	36mm
Function	Wet & Dry vacuuming
Voltage	220/240V
Length of Cable	7m



STANDARD ATTACHMENTS:

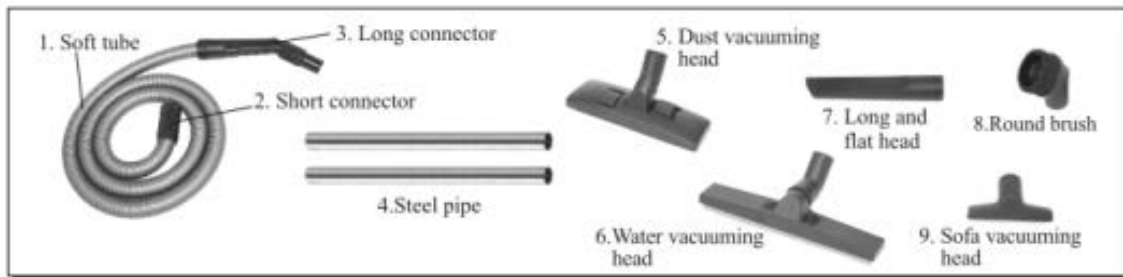

VC15L EXPLODED VIEW

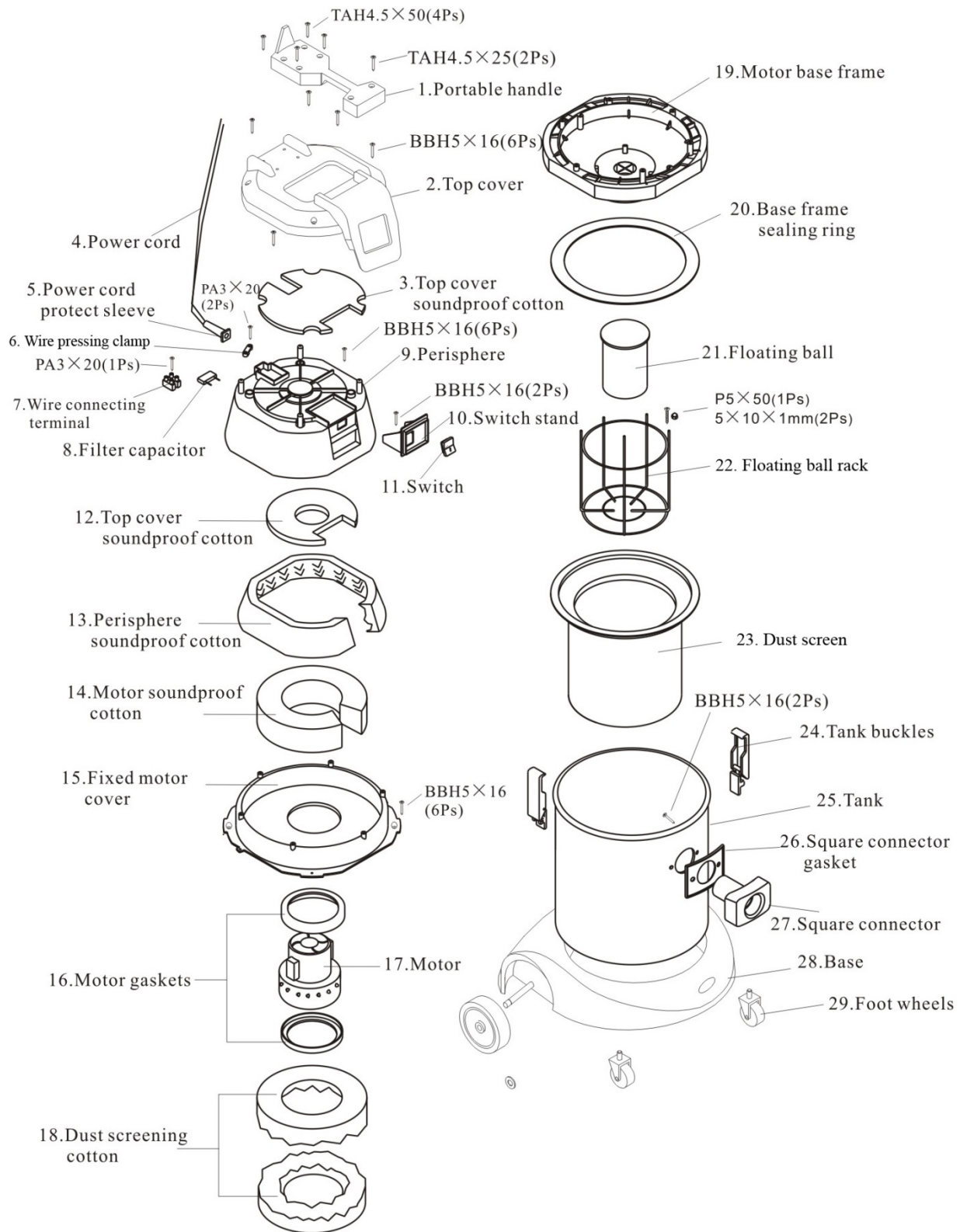

VC30L VACUUM CLEANER

TECHNICAL SPECIFICATIONS	
Model	VC30L Stainless Steel Tank
Power	1000W, single phase
Cooling System	Circulating
Capacity	30L
Height	78cm
Diameter	34.5cm
Air Flow	53L/s
Vacuum Suction	230 mbar
Accessories	40mm
Function	Wet & Dry vacuuming
Voltage	220/240V
Length of Cable	7m



STANDARD ATTACHMENTS:

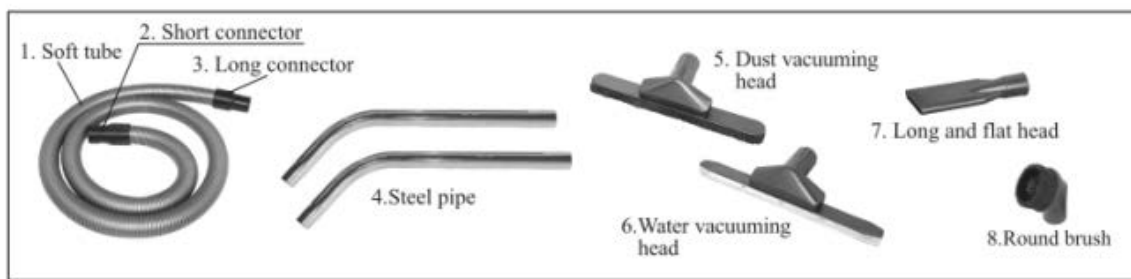

VC30L EXPLODED VIEW

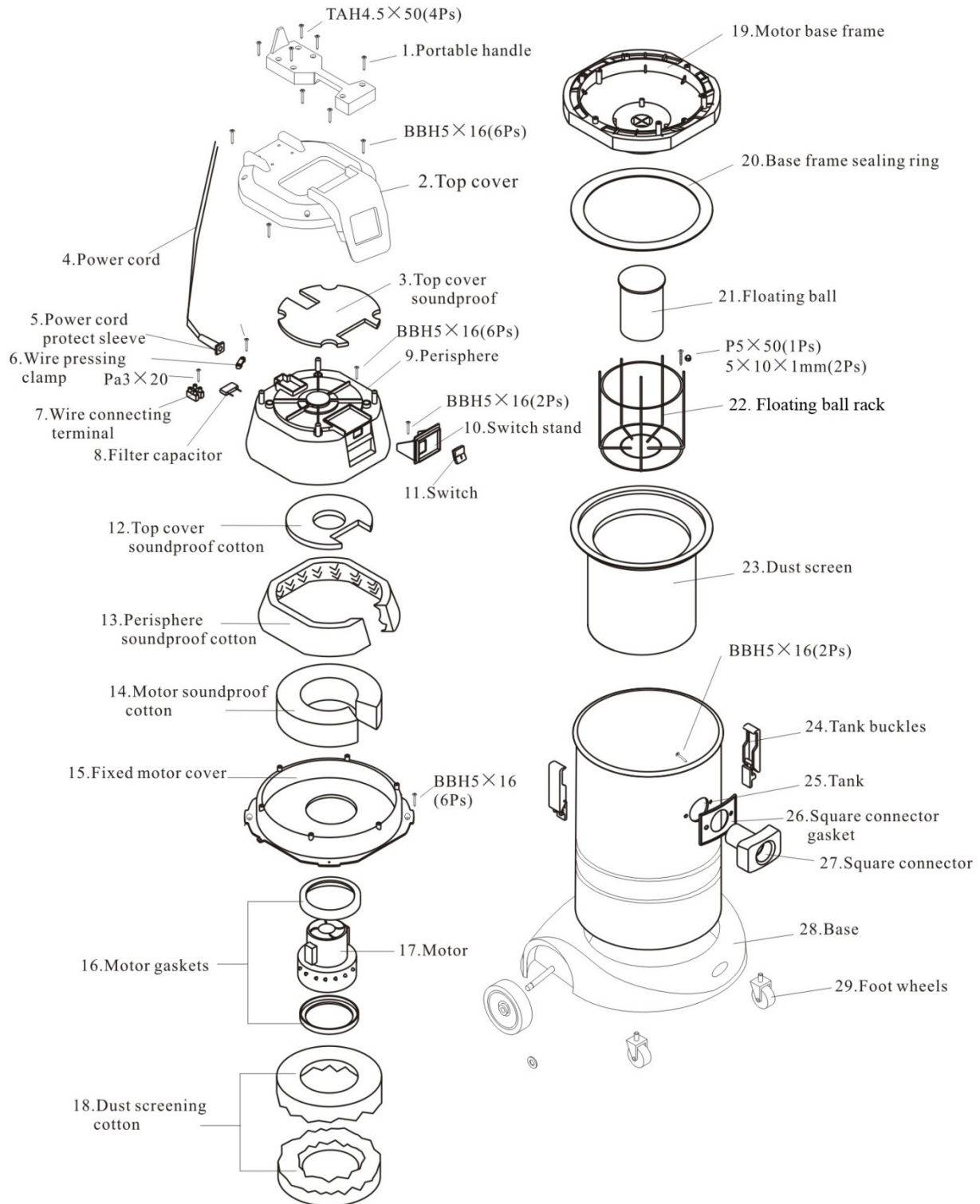

VC60L VACUUM CLEANER

TECHNICAL SPECIFICATIONS	
Model	VC60L Stainless Steel Tank
Power	2000W, single phase (twin motor)
Cooling System	Circulating
Capacity	60L
Height	97cm
Diameter	44cm
Air Flow	106L/s
Vacuum Suction	250 mbar
Accessories	40mm
Function	Wet & Dry vacuuming
Voltage	220/240V
Length of Cable	8m



STANDARD ATTACHMENTS:

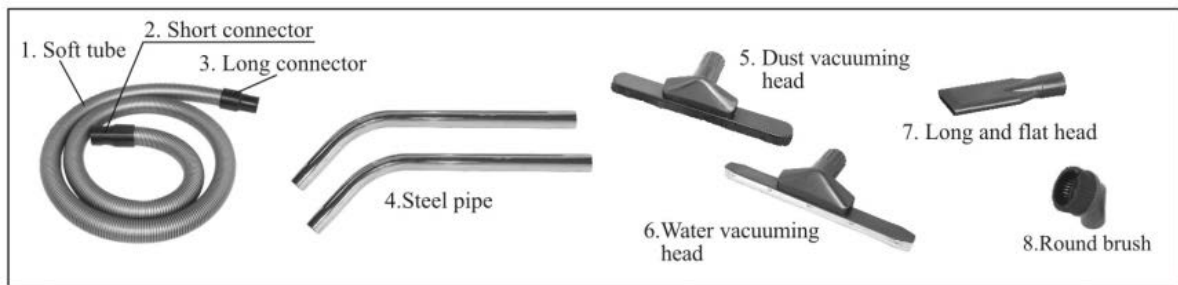

VC60L EXPLODED VIEW

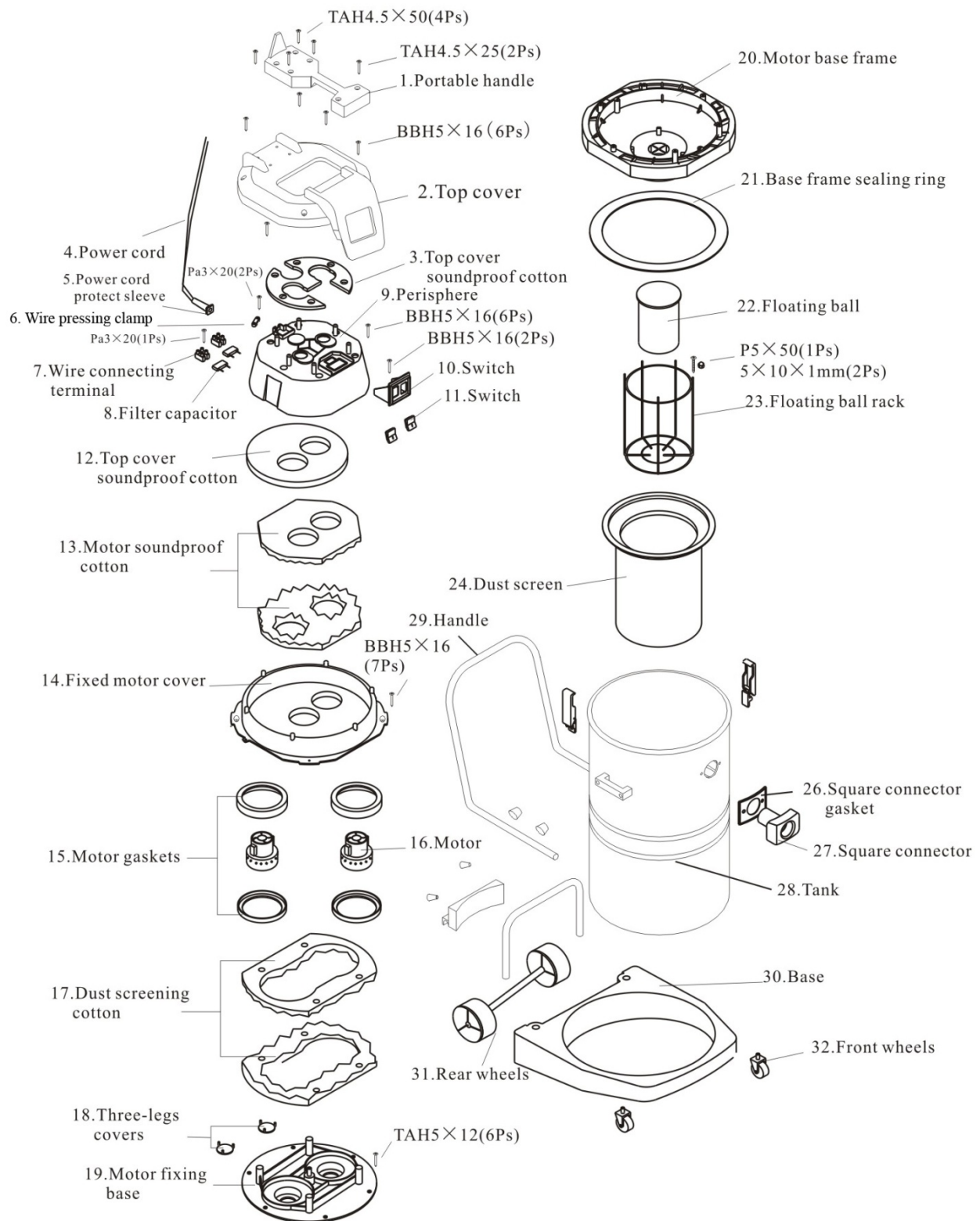

VC90LP VACUUM CLEANER

TECHNICAL SPECIFICATIONS	
Model	VC90LP Plastic Tank
Power	2000W, single phase (twin motor)
Cooling System	Circulating
Capacity	90L
Height	92cm
Diameter	44cm
Air Flow	120L/s
Vacuum Suction	250 mbar
Accessories	40mm
Function	Wet & Dry vacuuming
Voltage	220/240V
Length of Cable	8m



STANDARD ATTACHMENTS:

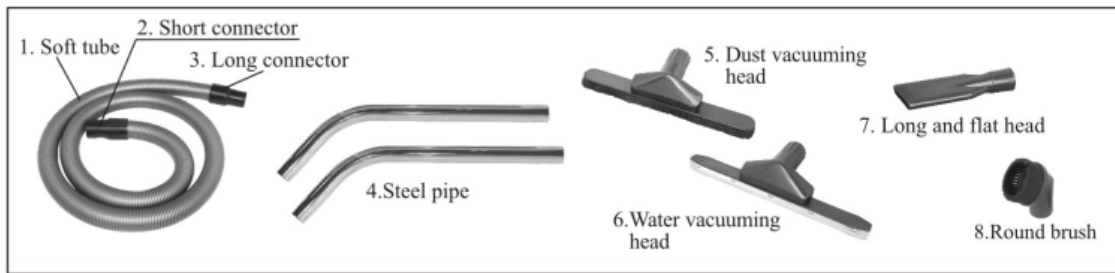

VC90LP EXPLODED VIEW

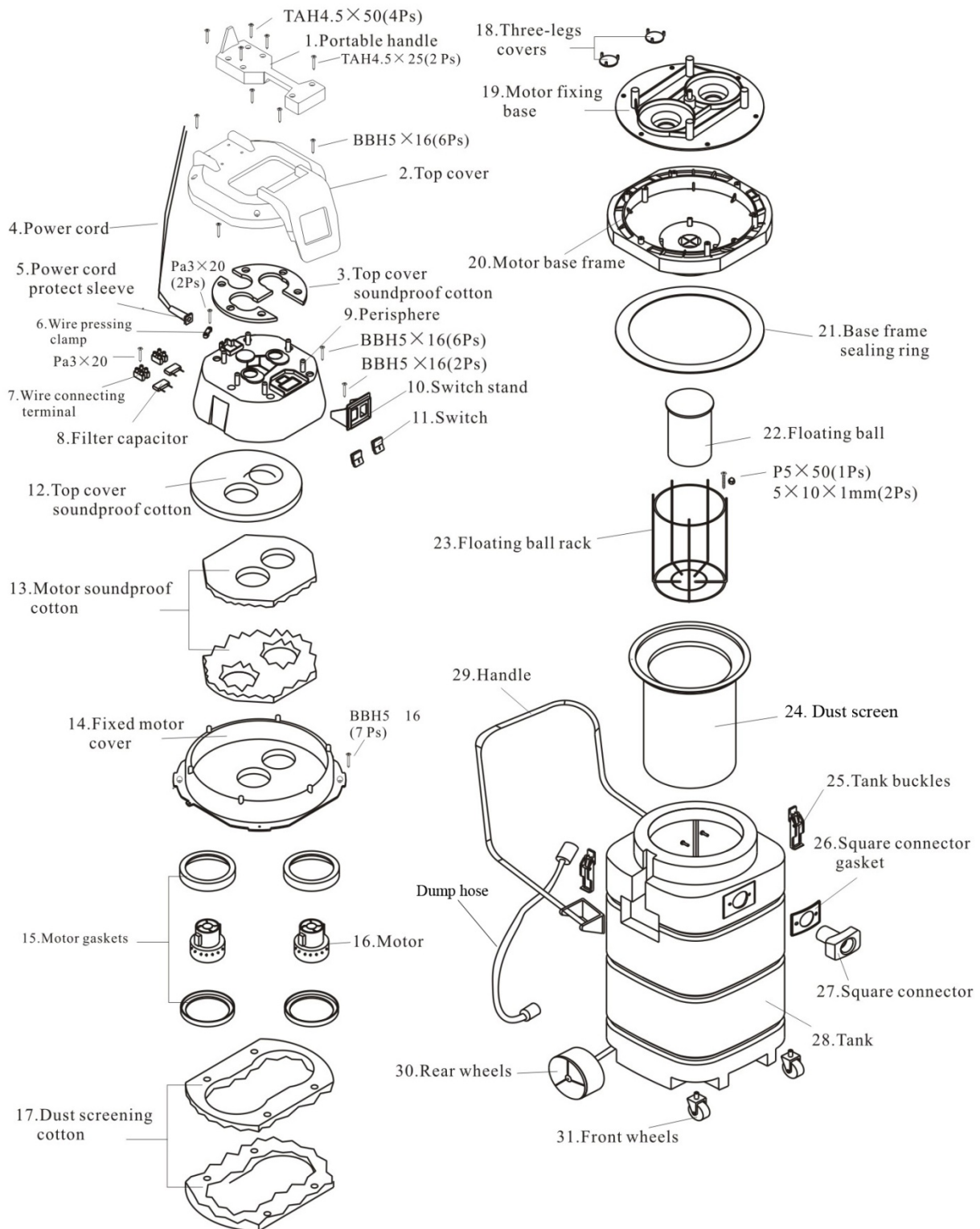



Cleanstar Pty Ltd

ABN: 51 121 002 104 ACN: 121 002 104

59 Radford Road, Reservoir VICTORIA 3073

Phone: (03) 9460 5655 Fax: (03) 9460 5666

Email: sales@cleanstar.com.au Web: www.cleanstar.com.au

CONDITIONS OF WARRANTY

This document outlines the terms and conditions of warranty for your Cleanstar product. This is an important document that should be kept with your proof of purchase documents in a safe place for future reference should you require service for your product.

Thank you for purchasing your new Cleanstar product. We are confident this product will give you trouble-free use and excellent service, provided the operator uses and maintains the product in accordance with the Instruction Manual. Please read the Instruction Manual carefully before using the product for correct operation and maintenance procedures, and store it in a safe place for future reference.

1. This is a parts and labour warranty against faulty or defective parts, materials or workmanship in manufacturing, when the product is used and operated in accordance with the Instruction Manual.
2. This product carries a 12 month (1 year) warranty period that commences from the original date of purchase by the first user/purchaser, and is not transferable.
3. This warranty only applies to products purchased and used in Australia.
4. At all times during the warranty period, Cleanstar shall, at its sole discretion, determine whether repair, replacement or refund will apply if the product has a valid warranty claim applicable to it.
5. The repair or replacement of the product under this warranty does not extend the original period of warranty.
6. Please note that this warranty will be voided in the following cases (which are not exhaustive) and the warranty does not apply to the cost of replacing any parts of the product resulting from:
 - Accidental damage;
 - Normal wear and tear;
 - Neglect, misuse or physical abuse by the operator, including failure to properly maintain or service;
 - Any alterations, modifications or tampering with the product without the prior written consent of Cleanstar;
 - Incomplete or improper installation;
 - Incorrect, improper or inappropriate operation;
 - Insect or vermin infestation;
 - Power surges, electrical storm damage or incorrect power supply/voltage;
 - Excessive use or use for which this product has not been designed;
 - Vacuuming up toner, powders, glass, hazardous, flammable or corrosive materials, plaster dust, concrete dust and other similar building or construction materials;
 - Failure to comply with the operating instructions contained in the Manual supplied with the product;
 - If the product is rented;
 - If the product is used outside of Australia;

- If the product was serviced or repaired by anyone other than Cleanstar, or one of Cleanstar's Authorised Service Agents (ASA). Cleanstar is unable to accept any responsibility under this warranty for any repair work not carried out by an ASA or from the use of non-genuine parts.
7. This warranty does not cover service calls, travelling time or consumable parts such as belts, dust bags, filters, hose or hose parts, rods and wands, floor tools and accessories, motor brushes and other like consumable items, unless defective in manufacture. In order to prolong the life of accessories and consumables, regular care and maintenance is recommended.
 8. Please retain your original proof of purchase which will be required before you can make a claim under this warranty. If proof of purchase can not be provided at the time of a warranty claim or service, any work carried out on the cleaner is chargeable.
 9. Any transportation and delivery costs involved in the repair of defective parts shall be borne by the claimant. In all instances, unless the product is transported by Cleanstar or a Cleanstar authorised representative, the product is transported at the owner's cost and risk while in transit to and from Cleanstar or its ASA.

Our goods come with guarantees that cannot be excluded under the Australian Consumer Law. You are entitled to a replacement or refund for a major failure and for compensation for any other reasonably foreseeable loss or damage. You are also entitled to have the goods repaired or replaced if the goods fail to be of acceptable quality and the failure does not amount to a major failure. The benefits conferred by this warranty are in addition to other rights and remedies under law in respect of the product to which this warranty relates.

TO INQUIRE ABOUT MAKING A CLAIM UNDER THIS WARRANTY, PLEASE FOLLOW THESE STEPS:

- a) carefully check the Instruction Manual and the terms of this warranty;
- b) have the name and model number of the appliance available;
- c) have the proof of purchase available (ie. invoice, receipt, etc) showing where the appliance was purchased from and date of purchase;
- d) call Cleanstar on **(03) 9460 5655** to speak to one of our customer service staff.